

# GRS 620



Motorised lock for emergency exits and access control

## **GROOM** PRODUCT ADVANTAGES

- DAS NFS 61-937 sheet XIV
- Automatic voltage selection : 12/24/48 V DC
- Surface-mounted or built-in fitting
- Specially developed for double action prehung door unit
- V-lock bolt adjustable in 3 sizes:
  - +/- 30 mm on the lateral side (special double action prehung door unit)
  - +/- 10 mm in height
- High resistance to forced entry: thrust and shearing of 1400 kg
- Weak energy consumption: 4.8 W in the idle state, 9.6 W in open/close phase
- Recommended for High rise buildings, Hospitals, Retirement Homes, Alzheimer care unit, Buildings open to the public, etc.



TECHNICAL CHARACTERISTICS	GRS 620
Power supply for access control	12/24/48 Vcc
Fire alarm Power Supply	24/48 Vcc
Automatic selection 12/24/48 V DC	YES
DAS NFS 61-937 sheet XIV	YES
Automatic unlocking when no voltage (fail safe)	YES
Aluminum, steel and wooden built-in fitting	YES
Surface-mounted fitting with stainless steel fitting kit	YES
Fitting on double action door	YES
Fitting on single action door	YES
High resistance to forced entry: Thrust and shearing of 1400 kg	YES
Bolt diameter 16 mm, stroke 20 mm	YES
Power in standby/action (Watt)	4,8 W / 9,6 W
Inrush current when the power is on (access control)	3 A during 0,1 s
Protection against polarity reversal	YES
Silent and rapid opening/closing (0.5 seconds)	YES
Clearance tolerance between electric strike and face plate from 4 to 10 mm	YES
Clearance tolerance from point «zero» up to 30 mm (double action door)	YES
Pluggable connectors of different colours (access controls)	YES
Beep in case of general default	YES
Automatic-reset in case of any mishap	YES
Time delay in locking	5/10/20/30 seconds
Automatic relocking	YES
Feedback contact - locked door	YES
Feedback contact - unlocked door	YES
Information transfer - locked door	YES
«3rd state» safety mode integrated as a standard	YES
Extended lock bolt of 40 mm (double door action)	YES
Mounting in horizontal or vertical position	YES
Unlocking by European cylinder (fail safe version)	OPTION
Unlocking + locking by European cylinder (fail secure version)	OPTION
Right and left reversible opening	YES

# GRS 620

## USE AND MOUNTING

### > BUILT-IN FITTING

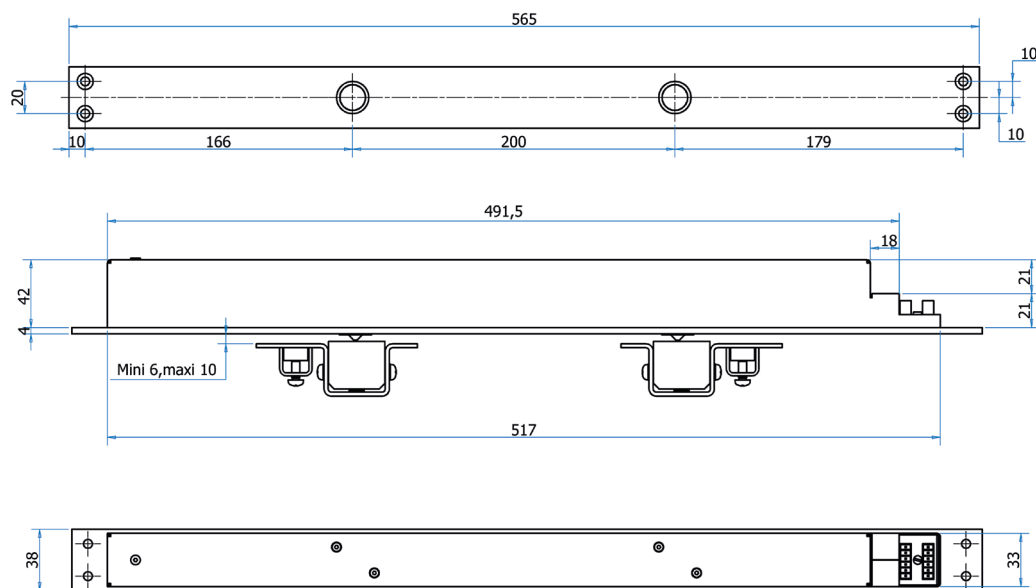

Round strike  
(wooden door)

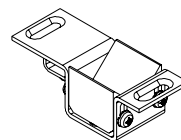
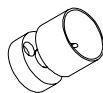

V model strike  
(metallic door)

### > SURFACE MOUNTED FITTING

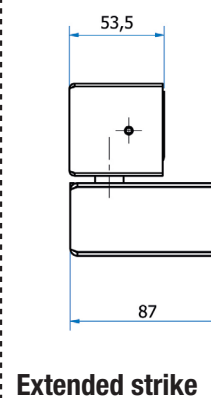
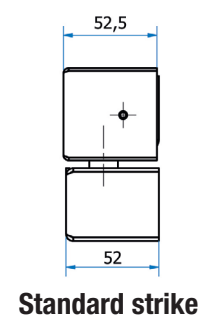
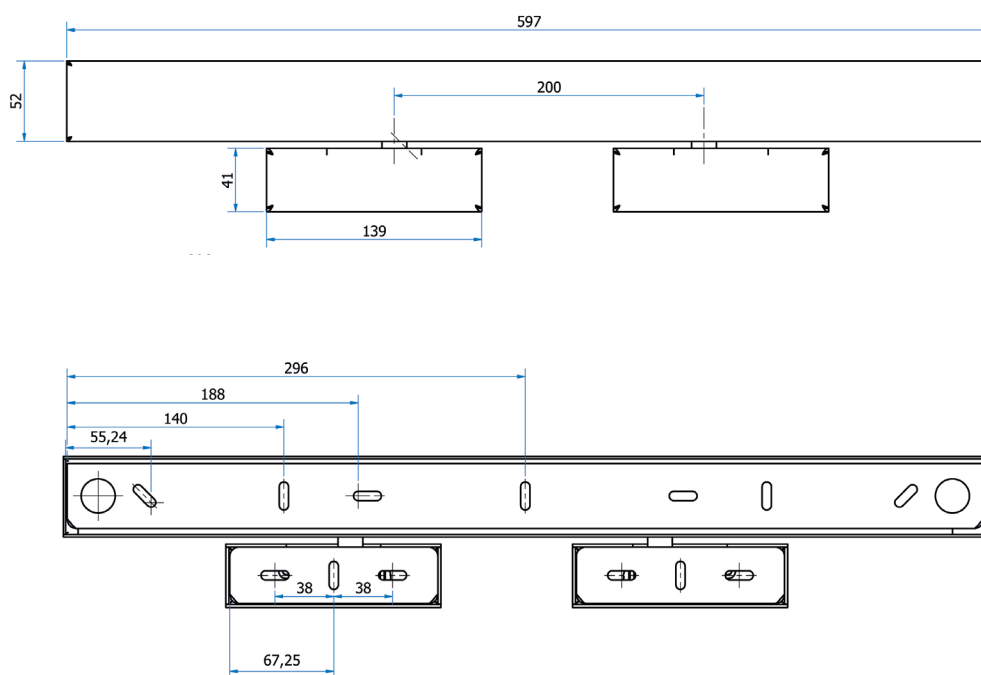

## > DESCRIPTION

GROOM motorised lock GRS 620 for access control and evacuation of emergency exits. Motorization with automatic voltage selection 12/24/48 V DC for control access (power supply 3 A) and automatic voltage selection 24/48 V DC for the fire alarm connection (9,6 watts maximum in operation and 4,8 W at rest).

- Built-in fitting version approved in PV DAS door with majority of technical doors manufacturers.
- Surface-mounted version with dimensions of less than 50 mm, allowing easy installation on lintel, in brushed stainless steel finish.
- Equipped with 3 dimensions adjustable strikes allowing a catch of space up to 30 mm and adapted to the dimension of the doors.
- Serial equipment of door contacts locked / unlocked, door closed and alarm fault.
- Equipped with a time delay adjustable from 5 to 30 s.
- 3rd condition mode series, reverse polarity protection.
- Silent and fast lock (0,5s) by 2 bolts of 16 diameter length 20mm resistant to 1400 kg of thrust and shearing.
- Versatile design for vertical and horizontal installation on single and double action doors.

*DAS NFS 61-937 Sheet XIV compliance*

### REFERENCES

## GRS 620

### GRS 623 DAS NFS 61-937

GRS623330	2 BOLTS MOTORISED LOCK, DAS NFS 61-937, BUILT-IN FITTING ROUND STRIKE
GRS623320	2 BOLTS MOTORISED LOCK, DAS NFS 61-937, COMPACT WITH 2 DOORS
GRS623220	2 BOLTS MOTORISED LOCK, DAS NFS 61-937, COMPACT WITH 1 DOOR
GRS623120	2 BOLTS MOTORISED LOCK, DAS NFS 61-937, PREPARED FOR CYLINDER

### GRS 622 FAIL SAFE MODELS

GRS622310	2 BOLTS MOTORISED LOCK, FAIL SAFE, COMPACT WITH 2 DOORS
GRS622210	2 BOLTS MOTORISED LOCK, FAIL SAFE, COMPACT WITH 1 DOOR
GRS622110	2 BOLTS MOTORISED LOCK, FAIL SAFE, PREPARED FOR CYLINDER

### GRS 621 SECURE MODELS

GRS621310	2 BOLTS MOTORISED LOCK, FAIL SECURE, COMPACT WITH 2 DOORS
GRS621210	2 BOLTS MOTORISED LOCK, FAIL SECURE, COMPACT WITH 1 DOOR
GRS621110	2 BOLTS MOTORISED LOCK, FAIL SECURE, PREPARED FOR CYLINDER

### GRS 628 SURFACE-MOUNTED FITTING KITS

GRS628300	SURFACE-MOUNTED FITTING KIT FOR COMPACT MODEL WITH 2 DOOR LEAVES
GRS628302	EXTENDED SURFACE-MOUNTED FITTING KIT OF 40 MM FOR VM COMPACT WITH 2 DOOR LEAVES
GRS628200	SURFACE-MOUNTED FITTING KIT FOR COMPACT MODEL WITH 1 DOOR LEAF
GRS628100	SURFACE-MOUNTED FITTING KIT FOR MODEL PREPARED FOR CYLINDER