

GRS 300

GROOM PATENT

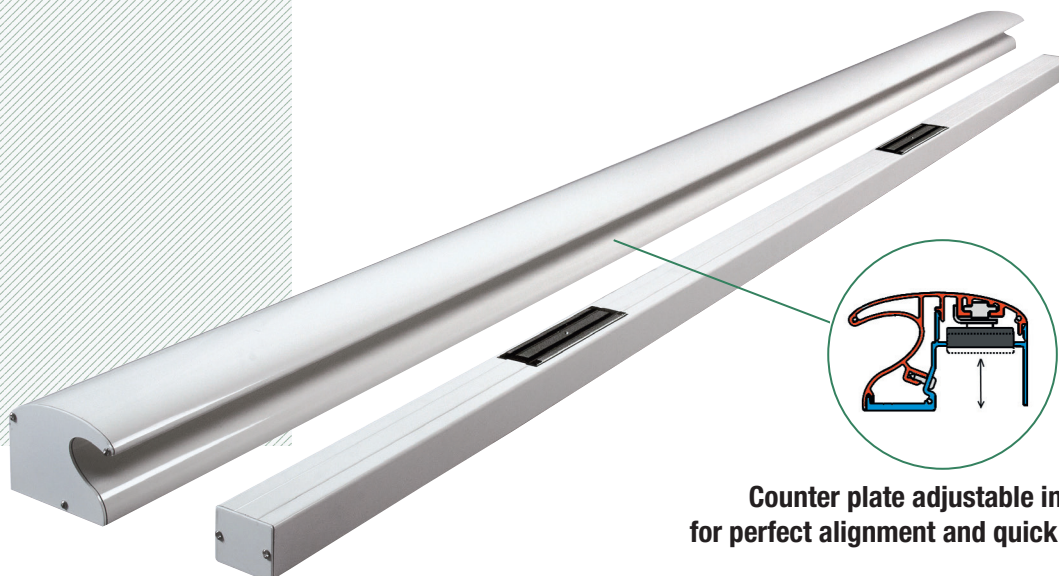

Counter plate adjustable in depth
for perfect alignment and quick installation

Electromagnetic profile handle for access control

GROOM PRODUCT ADVANTAGES

- Locking solution with maglock(s)
- Counter plate adjustable in depth for perfect alignment and quick installation
- GROOM innovation and exclusivity
- Developed in total collaboration with our installer customers
- Automatic voltage selection 12/24/48 V DC
- Information transfer as a standard
- Easy to install and to connect
- Reliability and quick installation
- DAS NFS 61-937 in 24 V DC and 48 V DC in 1/2/3/4 maglocks
- Multiples sizes available : 400/800/2500/3000 mm, 1/2/3/4 maglocks
- High rigidity of handle due to thickness of aluminum profiles
- Invisible fixings and lacquered aluminum profiles
- Installation in new and renovation
- Internal and external installation - No corrosion
- Design and ergonomic
- Recommended for Receiving Public Establishment (ERP), hospitals, retirement homes, tertiary, low-cost housing, ...
- Available in silver, white, black, 7016, raw or other RAL



TECHNICAL CHARACTERISTICS

GRS 300

Counter plate adjustable in depth	YES
12/24/48 V DC power supply	YES
Automatic voltage selection	YES
DAS NFS 61937 (24/48 V DC)	YES
Low consumption per maglock	6 Watts
Installation in new and renovation	YES
Information transfer as a standard	YES
Delivered with maglock(s) mounted and wired / ready to connect	YES
Profile rigidity (3 mm aluminum thickness)	YES
Invisible fixings	YES
Internal and external installation	YES
Reinforced handle	OPTION
Reinforced cover	OPTION
Available dimensions	400/800/2500/3000 mm / TAILORED
Number of maglocks	1 TO 4
Lacquered aluminum nozzles	YES
Standards colors: standard anodized, champagne anodized, 7016, RAL 9005, RAL 9010, raw	YES
RAL colors	YES

> PROFILE HANDLE

Assembly wedge

- 2 provided with the profile handle
- To be placed between the maglock support and the handle support
- Allows perfect centring on the entire height without pressure
- To be removed once the handle support is secured

Electro maglock support

- Secured on the door frame or the semi-secured leaf
- First piece to be mounted

GRS3x profile handle

Handle

- Attached and screwed-in on the handle support
- Screws provided and positions defined
- Last piece mounted

Handle support

- Fixed on the door
- Centred with the assembly wedge and the position of the suction pads
- Second piece to be mounted

Split hin

GRS3xx Reinforced cover (optional)

Support profile

Fastening cover clipped on the support

GRS39800x Reinforced handle (optional)

Pull handle profile

Fastening cover clipped on the pull handle

GRS 300

USE AND MOUNTING

> INSTALLATION

Profile handle GRS3xx

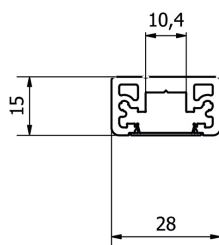
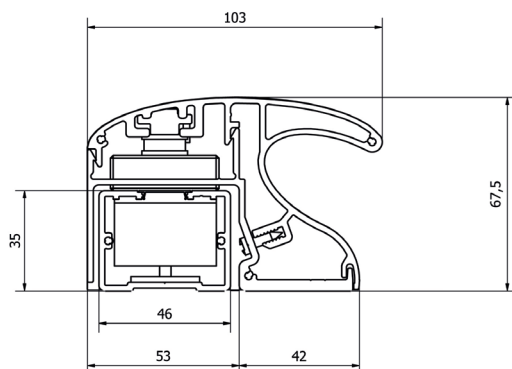

Reinforced cover
GRS39700x
(optional)

Reinforced handle GRS39800x (optional)

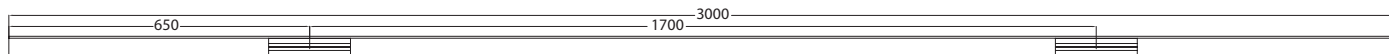
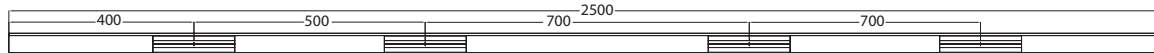
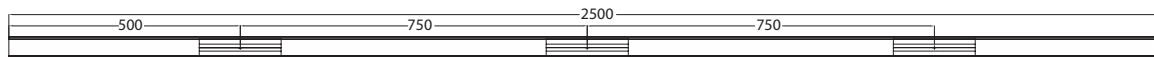
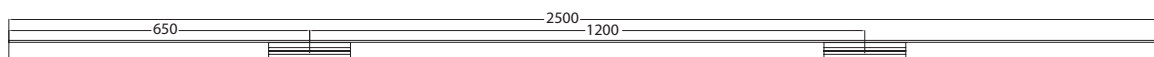
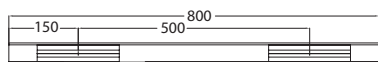
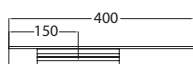
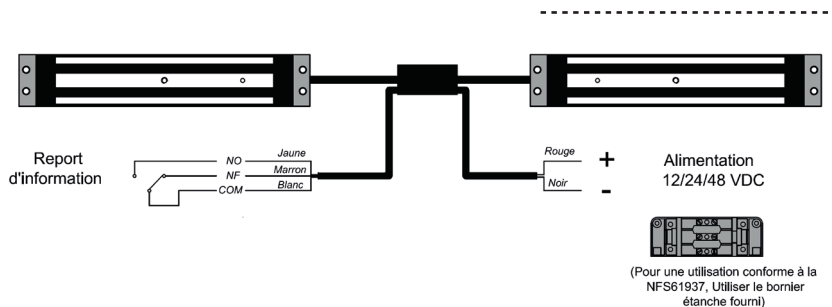
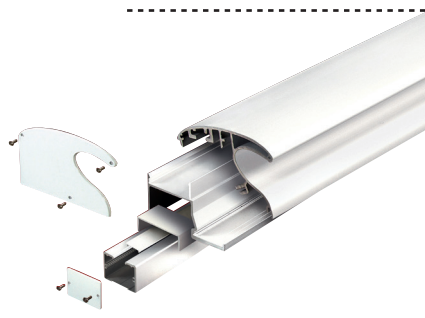
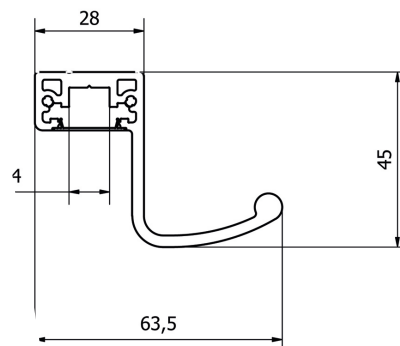

ANY OTHER CONFIGURATION ON REQUEST

> DESCRIPTION

GROOM profile handle with adjustable counter plate GRS 300 for access control and emergency exits, DAS NFS 61-937 Sheet XIV compliance in 24 V DC et 48 V DC, equipped with 300 kg maglocks with information transfer locked / unlocked door. Maglocks with automatic voltage selection 12/24/48 V DC and 1-pole electrical connection without polarity, without external step-down box or added plexo box, allowing easy connection. Maglocks with adjustable counter plate allowing perfect alignment.

- Anti-vandalism handle and aluminum support profile 3 mm thickness.
- Aluminum end caps lacquered in the RAL color of the handle.
- Profile handle tri-body design, ensuring reliable installation and handle rigidity.
- Smooth and continuous design, without rough edges for easy maintenance.

DAS NFS 61-937 Sheet XIV compliance

REFERENCES

GRS 300

GRS 300 L = 400 STD 1 MAGLOCK 300 KG

GRS32114X	STD L = 400 mm / 1 Maglock / 300 kg / 12/24 V DC
GRS33115X	DAS L = 400 mm / 1 Maglock / 300 kg / AUTOMATIC 12/24/48 V DC

GRS 300 L = 800 DAS NFS 61-937 2 MAGLOCKS 300 KG

GRS31514X	DAS L = 800 mm / 2 Maglocks / 300 kg / 12/24/48 V DC
GRS33515X	DAS L = 800 mm / 2 Maglocks / 300 kg / AUTOMATIC 12/24/48 V DC

GRS 300 L = 2500 DAS NFS 61-937

GRS31214X	DAS L = 2500 mm / 2 Maglocks / 300 kg / 12/24/48 V DC
GRS33215X	DAS L = 2500 mm / 2 Maglocks / 300 kg / AUTOMATIC 12/24/48 V DC
GRS33315X	DAS L = 2500 mm / 3 Maglocks / 300 kg / AUTOMATIC 12/24/48 V DC

GRS 300 L = 3000 DAS NFS 61-937

GRS33615X	DAS L = 3000 mm / 2 Maglocks / 300 kg / AUTOMATIC 12/24/48 V DC
-----------	---

REINFORCED HANDLE

GRS39810X	RAINFORCED HANDLE L = 400 mm
GRS39800X	RAINFORCED HANDLE L = 2500 mm

REINFORCED COVER L = 2500 MM

GRS39700X	REINFORCED COVER
-----------	------------------

Code X = Finish Code

1 = silver

6 = RAL 7016 satin

8 = other RAL (option)

5 = RAL 9005 black

7 = RAL 9010 white

9 = Raw ready to lacquer