

GRS 700

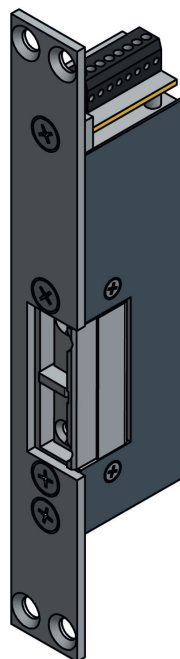

Electromechanical door locking for concealed frame installation

GROOM PRODUCT ADVANTAGES

- DAS NFS 61-937 sheet XIV
- Very low power consumption: 1.39 watts in 24 V DC, 2.3 watts en 48 V DC
- Simplified adjustments and fitting due to « Easy Mounting » concept
- Position contact integrated with series: locked / unlocked door, closed door

TECHNICAL CHARACTERISTICS	GRS 700
For emergency door	YES
For fire door	YES
24 V DC supply	YES 1.39 watts 58 mA
48 V DC supply	YES 2.3 watts 46 mA
Feedback contacts with series for locked / unlocked door	YES
Feedback contact for closed door	YES
Concealed installation	YES
For single action door, 1 door leaf or 2 door leaves	YES
Horizontal or vertical fitting	YES



A complete electrically operated lock-bolt GRS 700 DAS NFS 61-937 is composed by:

- an electrically operated lock-bolt, in 24 V DC or 48 V DC, right or left
- a right or left faceplate (rounded or squared edges)
- an opposite locks guaranteeing proper functioning (rounded or square edges)

> LOCK BOLTS

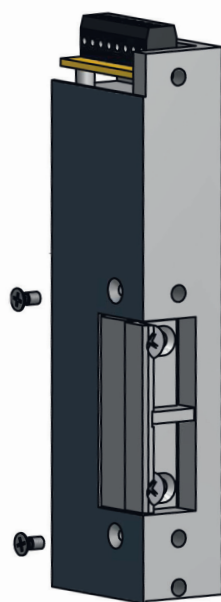
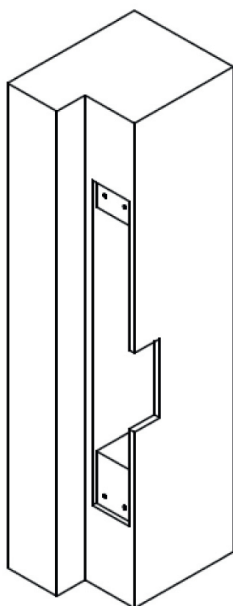

An electrically operated lock-bolt model of 24 V DC, 58 mA, 1.39 Watts, equipped with feedback contacts (locked / unlocked door and closed door) as a standard.
Right or left door model.

An electrically operated lock-bolt model of 48 V DC, 46 mA, 2.3 Watts, equipped with feedback contacts (locked / unlocked door and closed door) as a standard.
Right or left door model.

> FACEPLATES

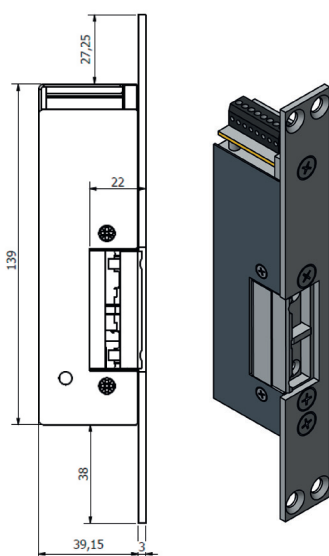

Right stainless steel faceplate
Rounded or squared edge models

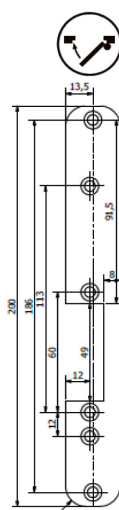
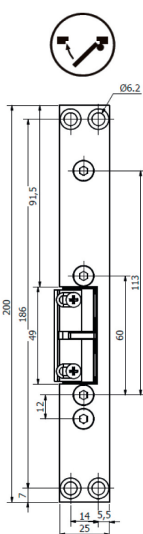

Left stainless steel faceplate
Rounded or squared edge models

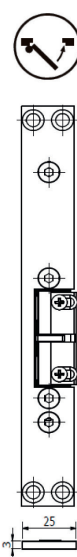

OPPOSITE LOCKS

Opposite locks are specially designed for good functioning of electrically operated lock-bolts GRS700. Reversible, they can be with square or round edges.

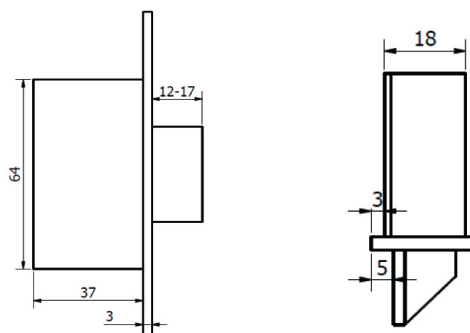

Lock GRS731311

> EASY MOUNTING

The « Easy Mounting » accessory is adaptable with all our GRS700 lock-bolts. It ensures easy fitting without any visible machining of the profile.

This accessory requires a specific faceplate available in right or left with round or square edges.

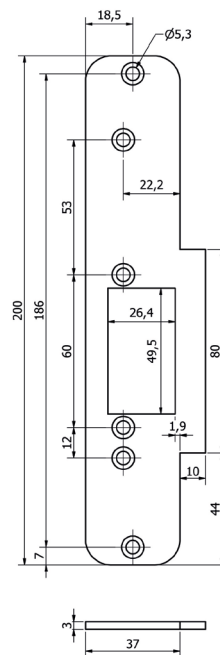
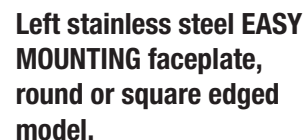

> DESCRIPTION

GROOM built-in electrically operated lock-bolt GRS 700 for access control and emergency exits.

- 24 V DC or 48 V DC power supply.
- Contact position of locked / unlocked door and contact position of closed door as a standard.
- Maximum consumption of 1.39 watts in 24 V DC.
- Strike provided with its faceplate and its opposite lock.

DAS NFS 61-937 Sheet XIV compliance

REFERENCES

GRS 700

GRS753101	ELECTRIC LOCK-BOLT GRS 700 DAS 24 V DC RIGHT
GRS752101	ELECTRIC LOCK-BOLT GRS 700 DAS 24 V DC LEFT
GRS753201	ELECTRIC LOCK-BOLT GRS 700 DAS 48 V DC RIGHT
GRS752201	ELECTRIC LOCK-BOLT GRS 700 DAS 48 V DC LEFT
GRS743442	SQUARED EDGED RIGHT FACEPLATE
GRS742442	SQUARED EDGED LEFT FACEPLATE
GRS743543	ROUNDED EDGED RIGHT FACEPLATE
GRS742543	ROUNDED EDGED LEFT FACEPLATE
GRS731312	OPPOSITE LOCK FOR SQUARE EDGED GRS700
GRS731311	OPPOSITE LOCK FOR ROUND EDGED GRS700
GRS793100	« EASY MOUNTING » ACCESSORY
GRS743842	SQUARE EDGED RIGHT « EASY MOUNTING » FACEPLATE
GRS742842	SQUARE EDGED LEFT « EASY MOUNTING » FACEPLATE
GRS743741	ROUND EDGED RIGHT « EASY MOUNTING » FACEPLATE
GRS742741	ROUND EDGED LEFT « EASY MOUNTING » FACEPLATE



LEFT



RIGHT